

ZONING MAP

TOWN OF SHERMAN, SHEBOYGAN COUNTY, WI

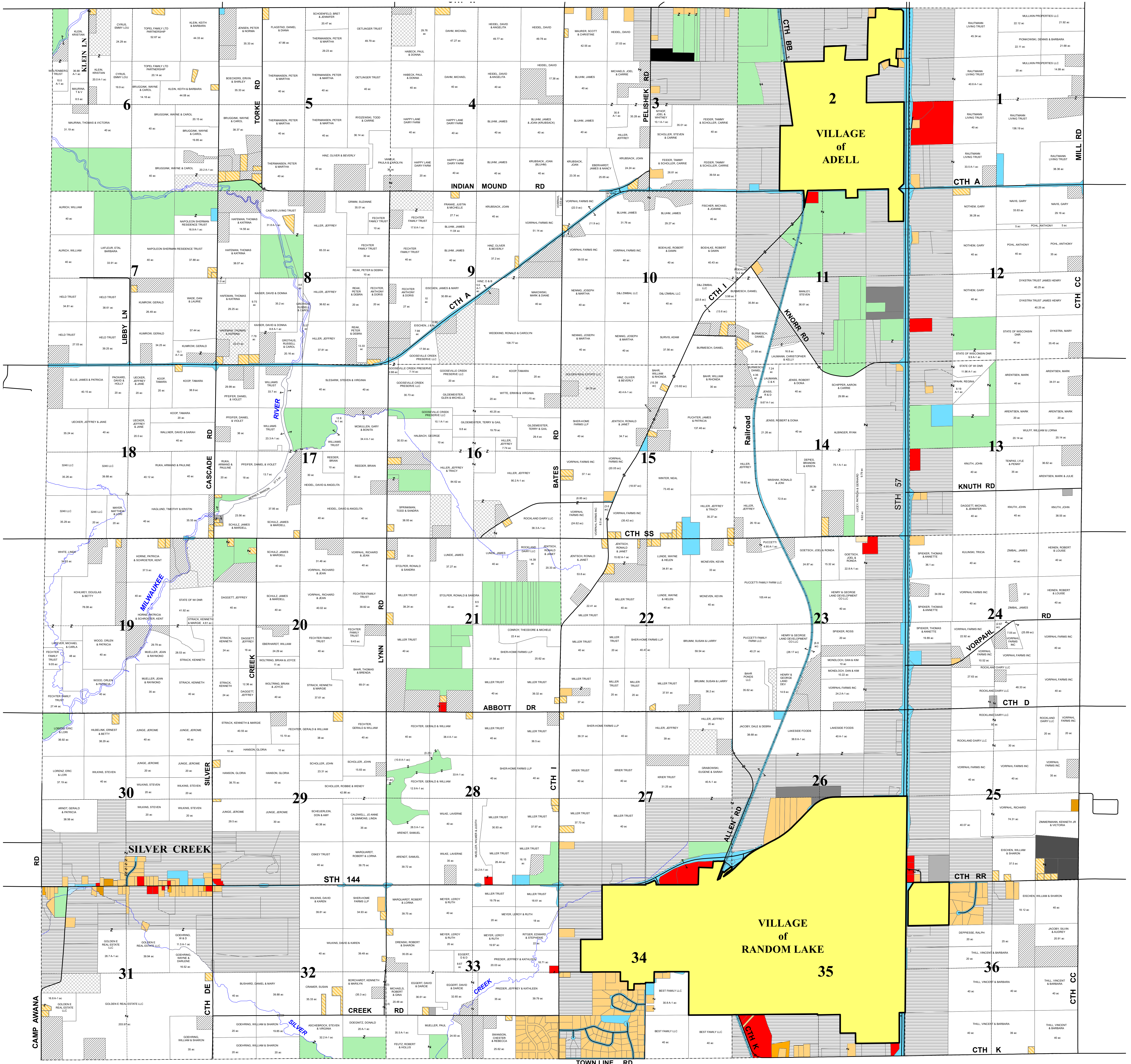

Map prepared by: UW-Extension Sheboygan County for rezonings up through 12/31/18
 Zoning boundaries were compiled from information provided by the Town of Sherman.
 Sheboygan County does not have general land use zoning and therefore has no jurisdiction relative to this map.
 Questions should be directed to the Town of Sherman Clerk.
 This map is not a survey of the actual boundary of any property this map.

LEGEND

Zoning Districts

* Within Farmland Preservation

	A-1*		B-1		M-1		R-1
	A-2*		C-1		M-2		R-2
	A-3		P-1		M-3		R-3
	A-1-PR*		P-2		M-4		R-4
							R-R

or indicates a single tax parcel

